



BDN FASTENERS

AS3566 Australian Standard
BUILDING FASTENERS

100% Made in Taiwan



ISO 9001:2015



AS3566
Australian Standard



CONTENTS

METAL-Tite™ Self-Drilling Screws

Fixing Cladding to Steel - Dual-Edge® Drill Point

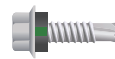

2

Fixing to Heavy Section Steel - No. 5 Drill Point



3

Crest Fixing Fasteners - Double Thread



4

Crest Fixing Fasteners - Full Thread



5

Stitching Fasteners - Reduced Point

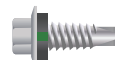

6

Stitching Fasteners - Needle Point

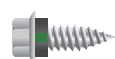

7

Concealed Fixing Fasteners



8

Framing Fasteners

FRAME-Tite™ Fixing to Steel Wall Frames



9

TRUSS-Tite™ Fixing Steel Roof and Floor Trusses



10

Truss to Plate Connection



11

TIMBER-Tite™ Self-Tapping Screws (Type 17)

Valley Fixing Fasteners



12

Crest Fixing Fasteners



13

AS3566 Australian Standard • 100% Made in Taiwan

BN3 METAL-Tite™ Dual-Edge® Self-Drilling Screws

Self Drilling Screws for Fixing Cladding to Metal

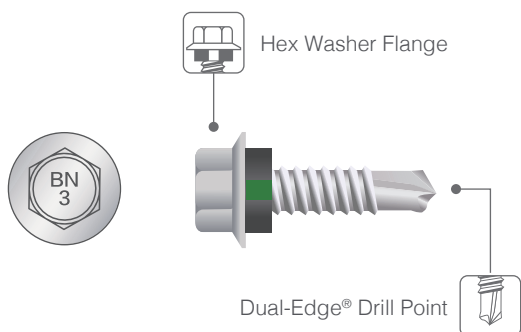
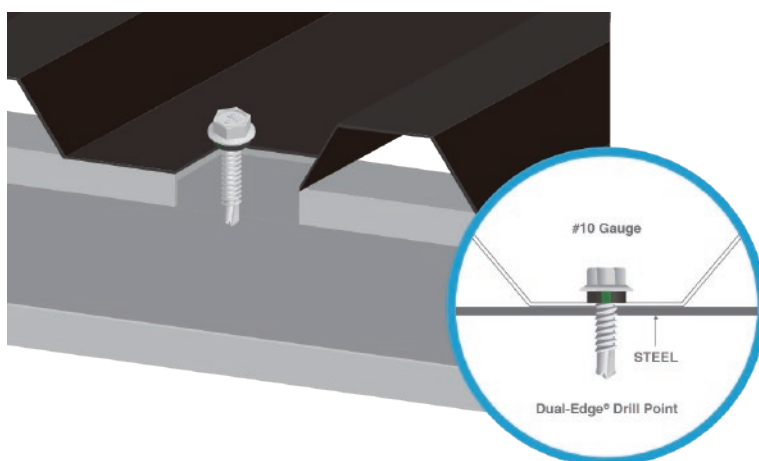

ADAPTER TO USE

Magnetic Hex Socket (5/16")

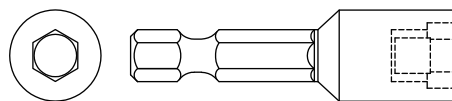

STEEL PENETRATION

Max. 4.0mm thick (For #10 gauge)

Max. 6.0mm thick (For #12 gauge)

PRODUCT FEATURES

Hex Washer Flange
Dual-Edge® Drill Point

WASHER

Eco-BDN® Green Washer



Eco-BDN
Green Washer

PART NUMBER

#10 Gauge

SDHC1016C3N 10-16 x 16mm
SDHC1019C3N 10-16 x 19mm
SDHC1025C3N 10-16 x 25mm

#12 Gauge

SDHC1220C3N 12-14 x 20mm
SDHC1225C3N 12-14 x 25mm
SDHC1230C3N 12-14 x 30mm
SDHC1235C3N 12-14 x 35mm

SST 1000 hrs + Kesternich 7 cycles

AS3566 Australian Standard • 100% Made in Taiwan

BN3 METAL-Tite™ Heavy Duty Self-Drilling Screws

Self Drilling Screws for Fixing to Thick Steel

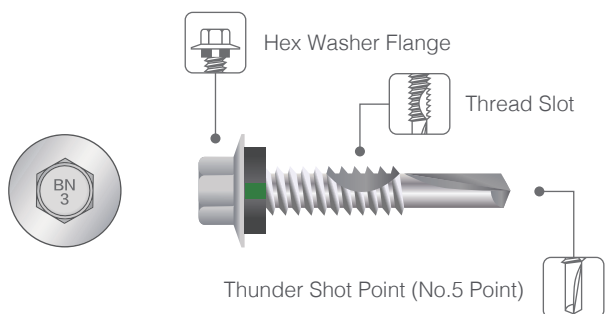
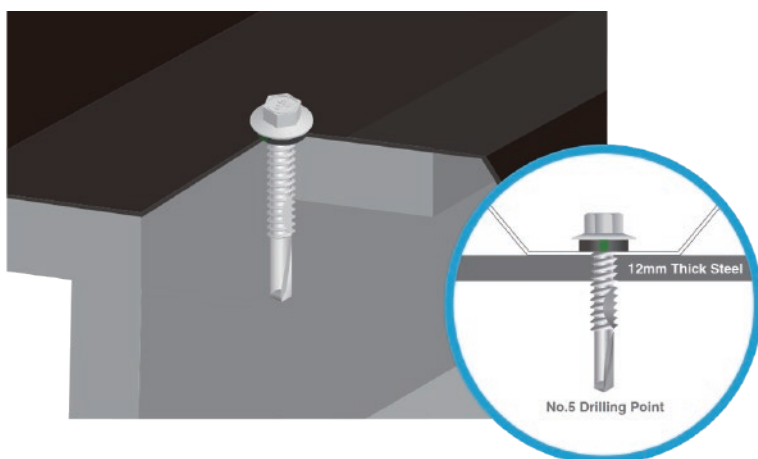

ADAPTER TO USE

Magnetic Hex Socket (5/16")

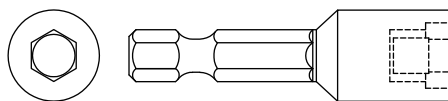

STEEL PENETRATION

Max. 12.5mm thick

PRODUCT FEATURES

Hex Washer Flange
Thread slot
No.5 Drilling Point

WASHER

Eco-BDN® Green Washer



Eco-BDN
Green Washer

PART NUMBER

#12 Gauge

SDH5F1232C3N 12-24 x 32mm

SDH5F1238C3N 12-24 x 38mm

SDH5F1250C3N 12-24 x 50mm

SST 1000 hrs + Kesternich 7 cycles

AS3566 Australian Standard • 100% Made in Taiwan

BN3 METAL-Tite™ Dual-Edge® Self-Drilling Screws

Self Drilling Screws for Fixing Roof Sheetting to Metal - Double Thread

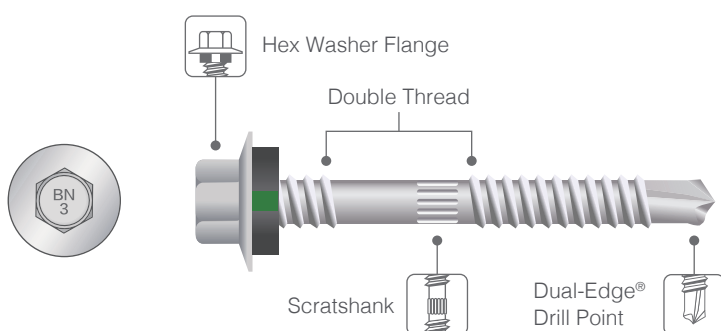
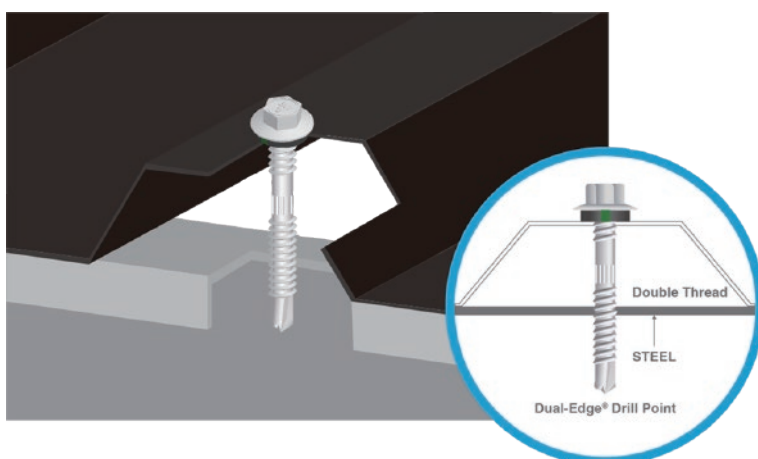

ADAPTER TO USE

Magnetic Hex Socket (5/16")

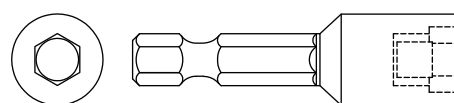

STEEL PENETRATION

Max. 6.0mm thick (For #12 gauge)

PRODUCT FEATURES

Hex Washer Flange
Dual-Edge® Drill Point
Double Thread
Scratchank

WASHER

Eco-BDN® Green Washer



Eco-BDN
Green Washer

PART NUMBER

#12 Gauge

SDHCG1250C3N 12-14 x 50mm

SDHCG1255C3N 12-14 x 55mm

SDHCG1265C3N 12-14 x 65mm

SDHCG1275C3N 12-14 x 75mm

SDHCG1285C3N 12-14 x 85mm

SDHCG12110C3N 12-14 x 110mm

SDHCG12130C3N 12-14 x 130mm

SST 1000 hrs + Kesternich 7 cycles

AS3566 Australian Standard • 100% Made in Taiwan

BN3 METAL-Tite™ Dual-Edge® Self-Drilling Screws

Self Drilling Screws for Fixing Roof Sheetting to Metal - Full Thread

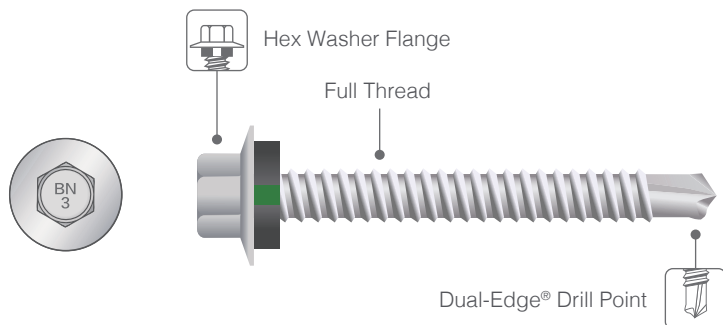
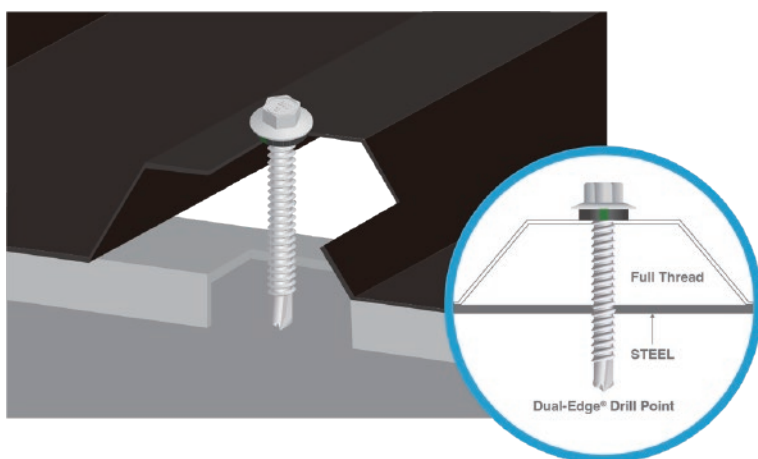

ADAPTER TO USE

Magnetic Hex Socket (5/16")

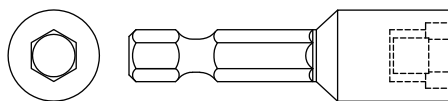

STEEL PENETRATION

Max. 6.0mm thick (For #12 gauge)

PRODUCT FEATURES

Hex Washer Flange
Full Thread
Dual-Edge® Drill Point

WASHER

Eco-BDN® Green Washer



Eco-BDN
Green Washer

PART NUMBER

#12 Gauge

SDHC1245C3N	12-14 x 45mm	SDHC1275C3N	12-14 x 75mm
SDHC1255C3N	12-14 x 55mm	SDHC1290C3N	12-14 x 90mm
SDHC1265C3N	12-14 x 65mm		

SST 1000 hrs + Kesternich 7 cycles

AS3566 Australian Standard • 100% Made in Taiwan

BN3 METAL-Tite™ Stitching Fasteners

Stitching Fasteners - Reduced Point

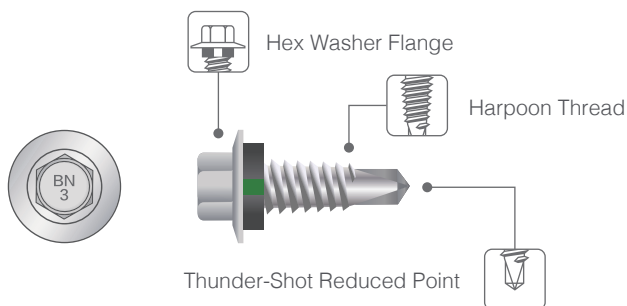
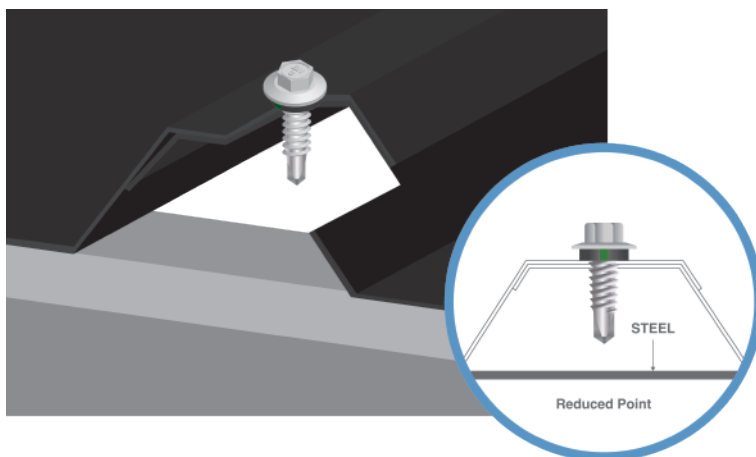

ADAPTER TO USE

Magnetic Hex Socket (5/16")

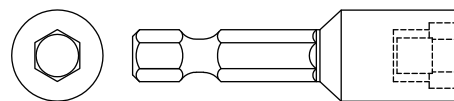

STEEL PENETRATION

Max. drilling capacity 1+1mm thick

PRODUCT FEATURES

Hex Washer Flange
Thunder-Shot Reduced Point
Harpoon Thread

WASHER

Eco-BDN® Green Washer



Eco-BDN
Green Washer

PART NUMBER

#15 Gauge

SDHC1520C3N 15-15 x 20mm

SST 1000 hrs + Kesternich 7 cycles

AS3566 Australian Standard • 100% Made in Taiwan

BN3 METAL-Tite™ Stitching Fasteners

Stitching Fasteners - Needle Point

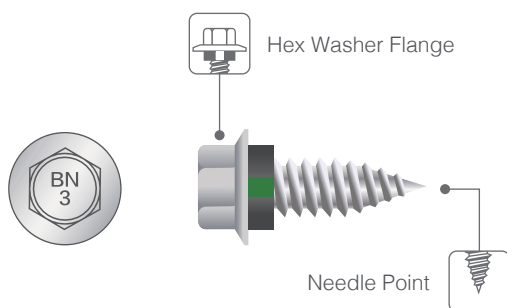
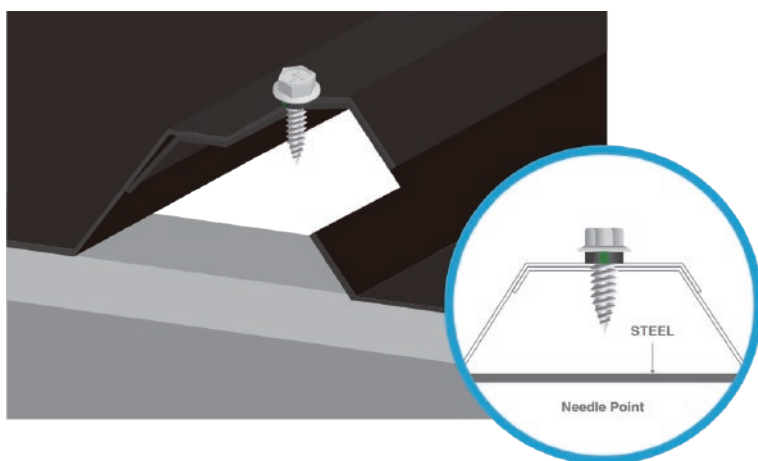

ADAPTER TO USE

Magnetic Hex Socket (5/16")

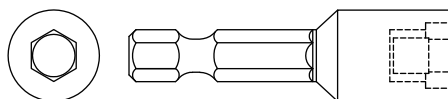

STEEL PENETRATION

Max. drilling capacity 1+1mm thick

PRODUCT FEATURES

Hex Washer Flange
Needle Point

WASHER

Eco-BDN® Green Washer



Eco-BDN
Green Washer

PART NUMBER

#10 Gauge

SDHST1019C3N 10-16x19mm

SST 1000 hrs + Kesternich 7 cycles

AS3566 Australian Standard • 100% Made in Taiwan

BN3 METAL-Tite™ Concealed Fixing Fasteners

Fixing sheeting to steel where a low profile is required

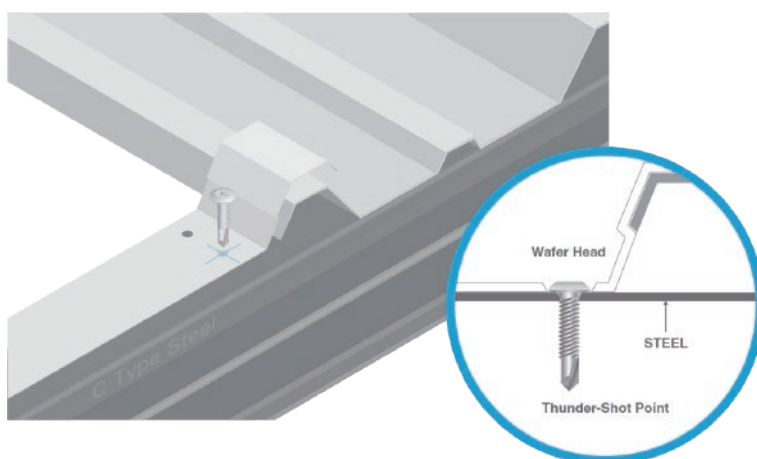

ADAPTER TO USE

Philips Bit (PH2+)



STEEL PENETRATION

Max. 4.0mm thick

PRODUCT FEATURES

Wafer Head
Philips Drive
Thunder-Shot Point

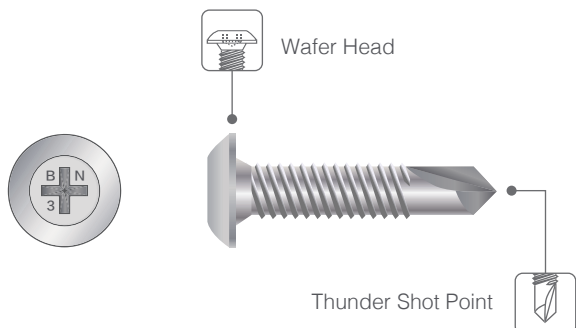

PART NUMBER

SDWF1016C3 10-24 x 16mm

SDWF1022C3 10-24 x 22mm

SST 1000 hrs + Kesternich 7 cycles

AS3566 Australian Standard • 100% Made in Taiwan

BN3 FRAME-Tite™ Framing Fasteners

Framing Fasteners - FRAME-Tite™ Fixing to Steel Wall Frames

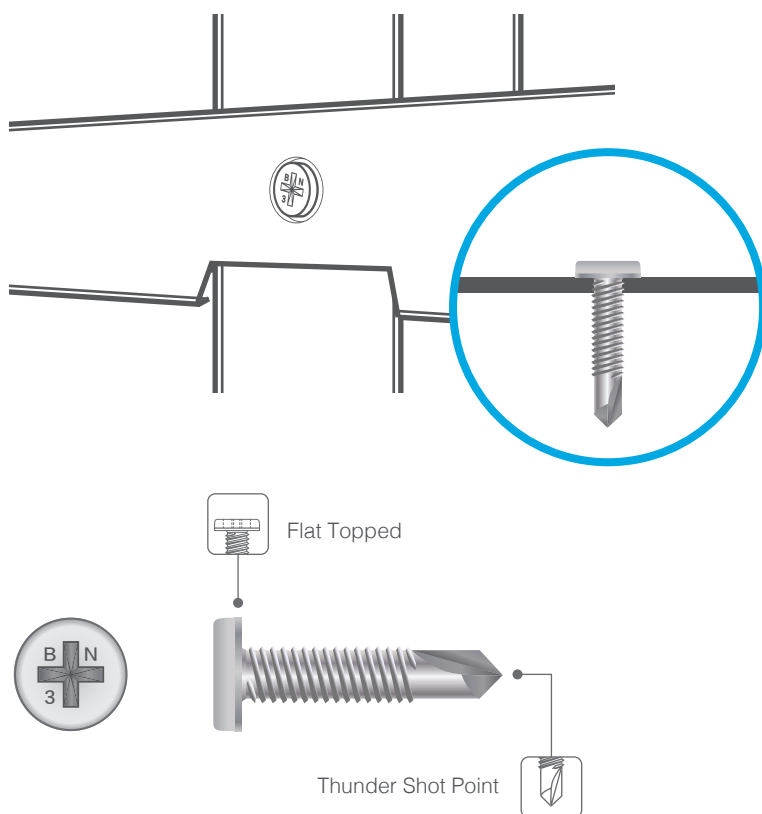

ADAPTER TO USE

Philips Bit (PH3+)



STEEL PENETRATION

Max. 4.0mm thick

PRODUCT FEATURES

- Smooth flat top head for discreet fixing
- Superior holding strength
- Easy application

PART NUMBER

SDFHSF0622C3 M6.0-1.00 x 22mm

SST 1000 hrs + Kesternich 7 cycles

AS3566 Australian Standard • 100% Made in Taiwan

BN3 TRUSS-Tite™ Framing Fasteners

Framing Fasteners - TRUSS-Tite™ Fixing Steel Roof and Floor Trusses

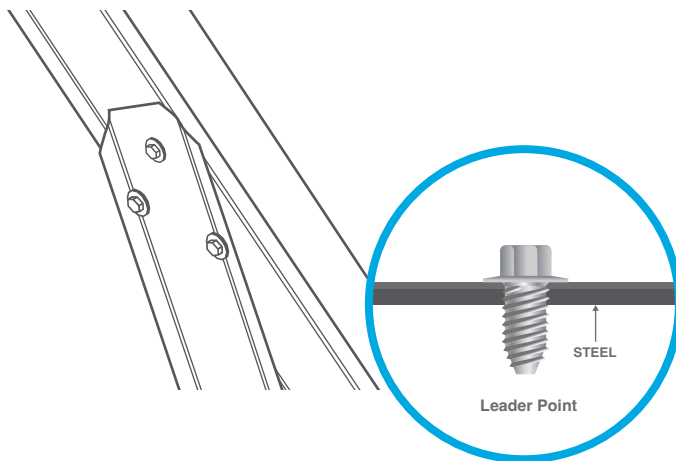

ADAPTER TO USE

Magnetic Hex Socket (5/16")

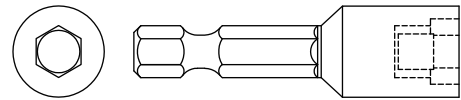

STEEL PENETRATION

From 0.75mm to 1.6mm thick

PRODUCT FEATURES

- Superior holding strength
- Self space tapping point makes it easy to start and align in the punched hole
- Easy application

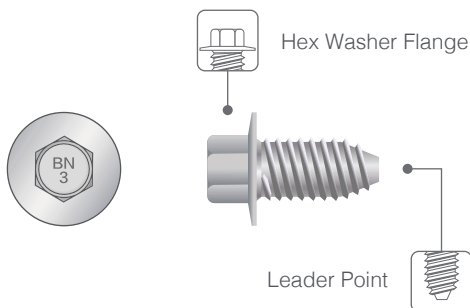

PART NUMBER

SDHTSF0816C3 M8.0-2.12x16mm

SST 1000 hrs + Kesternich 7 cycles

AS3566 Australian Standard • 100% Made in Taiwan

BN3 METAL-Tite™ Dual-Edge® Framing Fasteners

Framing Fasteners - Truss to Plate Connection

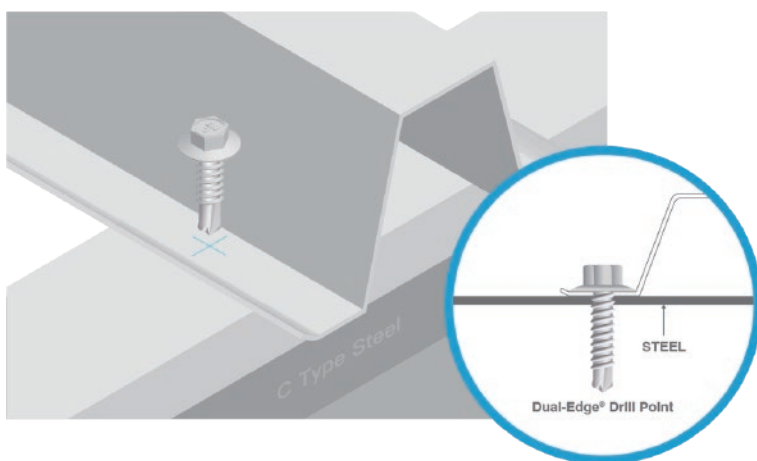

ADAPTER TO USE

Magnetic Hex Socket (5/16")

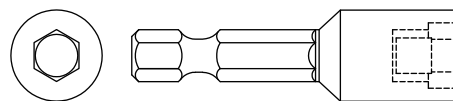

STEEL PENETRATION

Max. drilling capacity 1.5+1.5mm thick

PRODUCT FEATURES

Dual-Edge® Drill Point
High pull-out strength

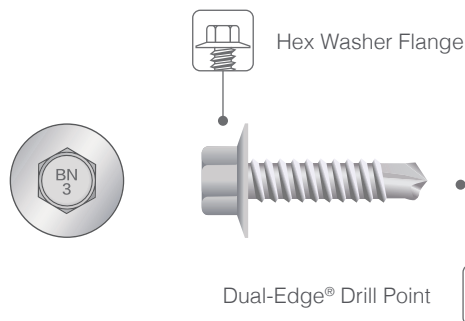

PART NUMBER

SDHCF1220C3 12-14 x 20mm

SST 1000 hrs + Kesternich 7 cycles

AS3566 Australian Standard • 100% Made in Taiwan

BN3 **TIMBER-Tite™** Self-Tapping Screws (Type 17)

Fixing roof sheeting to timber - Valley Fixing Fasteners

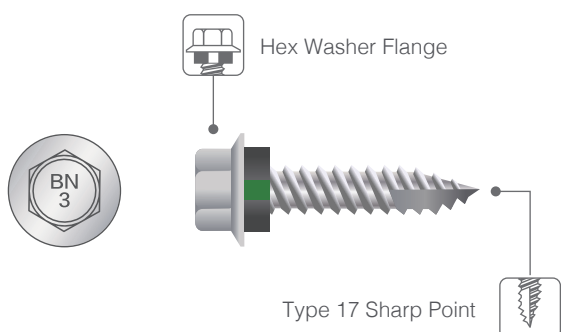
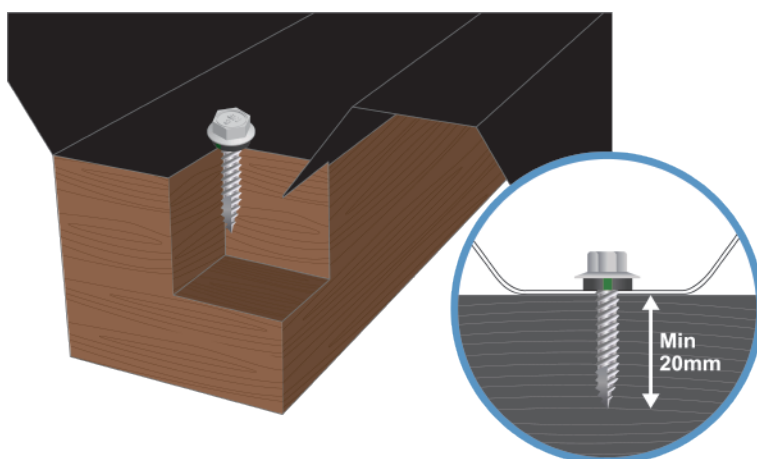

ADAPTER TO USE

Magnetic Hex Socket (5/16")

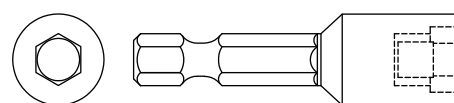

TIMBER PENETRATION

Min. 20mm penetration

PRODUCT FEATURES

Hex Washer Flange
Type 17 Sharp Point

WASHER

Eco-BDN® Green Washer



Eco-BDN
Green Washer

PART NUMBER

#10 Gauge

T17H1020C3N 10-12 x 20mm

SST 1000 hrs + Kesternich 7 cycles

AS3566 Australian Standard • 100% Made in Taiwan

BN3 **TIMBER-Tite™** Self-Tapping Screws (Type 17)

Fixing roof sheeting to timber - Crest Fixing Fasteners

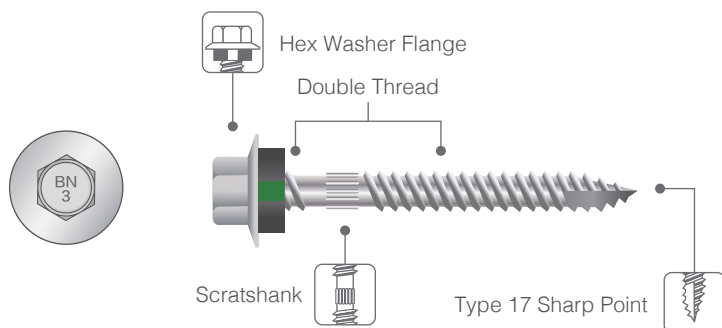
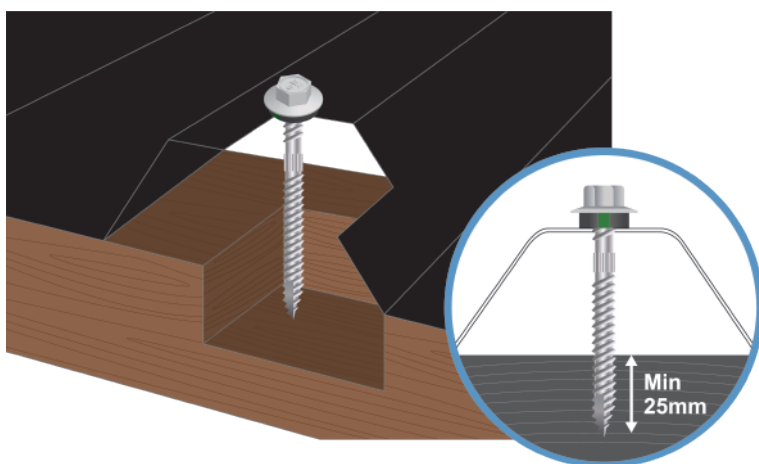

ADAPTER TO USE

Magnetic Hex Socket (5/16")

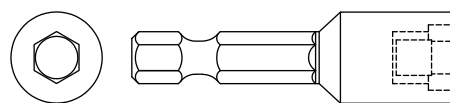

TIMBER PENETRATION

Min. 25mm penetration

PRODUCT FEATURES

Hex Washer Flange
Type 17 Sharp Point
Double Thread
Scratchank

WASHER

Eco-BDN® Green Washer



Eco-BDN
Green Washer

PART NUMBER

#12 Gauge

T17HCG1250C3N 12-11 x 50mm

T17HCG1265C3N 12-11 x 65mm

T17HCG1275C3N 12-11 x 75mm

SST 1000 hrs + Kesternich 7 cycles

Quality Assurance



AS3566
Australian Standard



To show our commitment to being a trustworthy supplier, and provide the best product and services, **BDN Fasteners®** are manufactured and quality controlled following ISO standards, and is of course, ISO-9001:2015 certified.

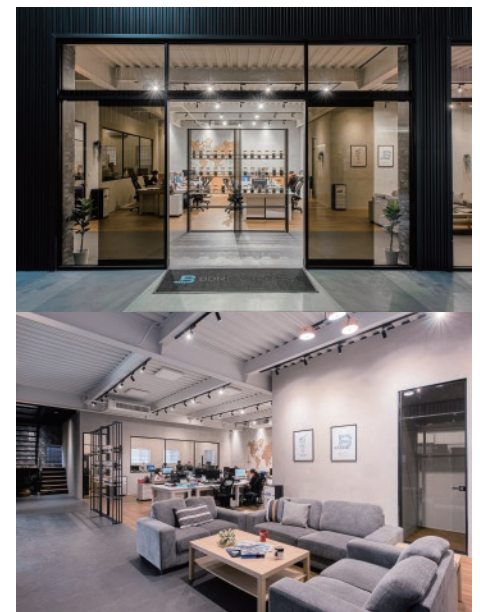

SGS Certification

BDN Fasteners BN3 Series screws are regularly sent to SGS for Kesternich & Spray Salt Test (1000 hrs) certification.

As part of our new quality assurance policy, which aims to provide high quality, third-party laboratory certified products – customers will now receive the most up-to-date corrosion resistance certifications upon request.

QUALITY CONTROL IN PROCESS



– PRE-PRODUCTION INSPECTION

Drawing Check
Specific Conditions Check

– HEADING / THREADING / THREADING / PINCH POINTING

Machinery Condition Check
Molds and Dies Inspection and Setup

– HEAT TREATMENT

Strictly controlled process
Fully equipped with well maintained case depth and hardness testers.

– SURFACE TREATMENT

Well equipped with salt-spray and corrosion test machinery.

– PRE-SHIPMENT INSPECTION

Manual Sorting and Rearrangement
Optical Sorting (Optional)

– FINAL INSPECTION

Dimensions
Functionality
Aesthetics

– PRE-SHIPMENT SAMPLES SENT UPON REQUEST

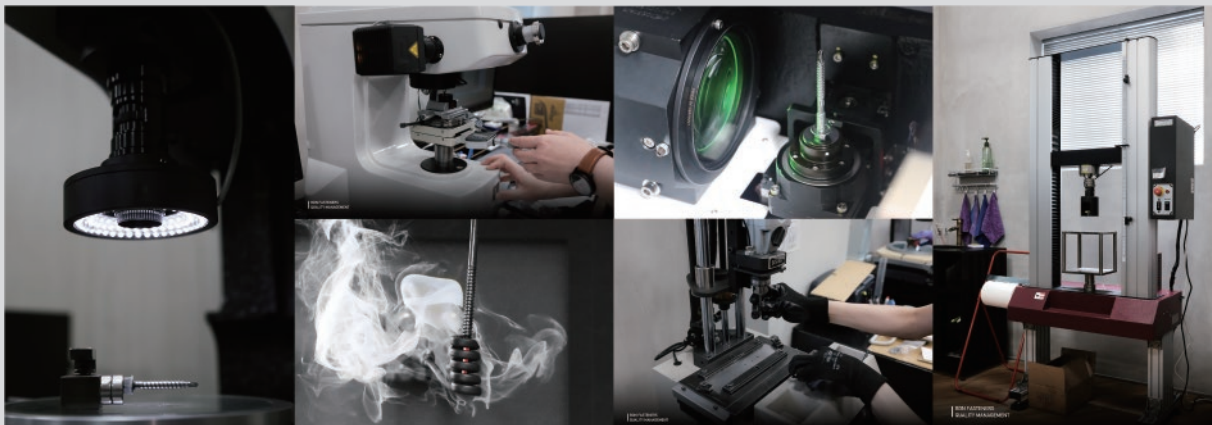

Ruspert Coating



BN3™ Silver Ruspert Coating consists of multiple layers of specially formulated, corrosion resistant chemicals, comes with an impressive 40 year warranty, and can easily withstand 1000hrs of salt spray test (AS 2331.3.1-2001), and 15 Kesternich cycles (DIN50018 2.0 SFW).

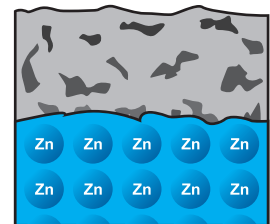
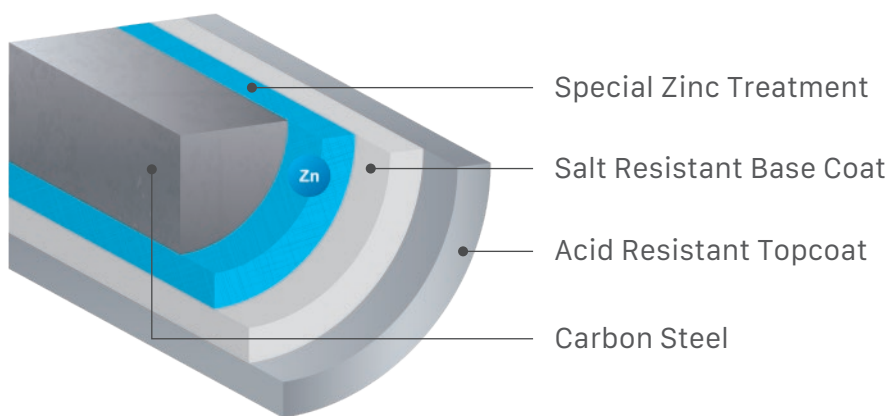

Conventional Coating

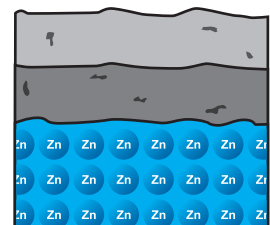

BDN® Ruspert Coating



BDN Fasteners® BN3 Series screws are regularly sent to SGS for Kesternich & Spray Salt Test (1000 hrs) certification.



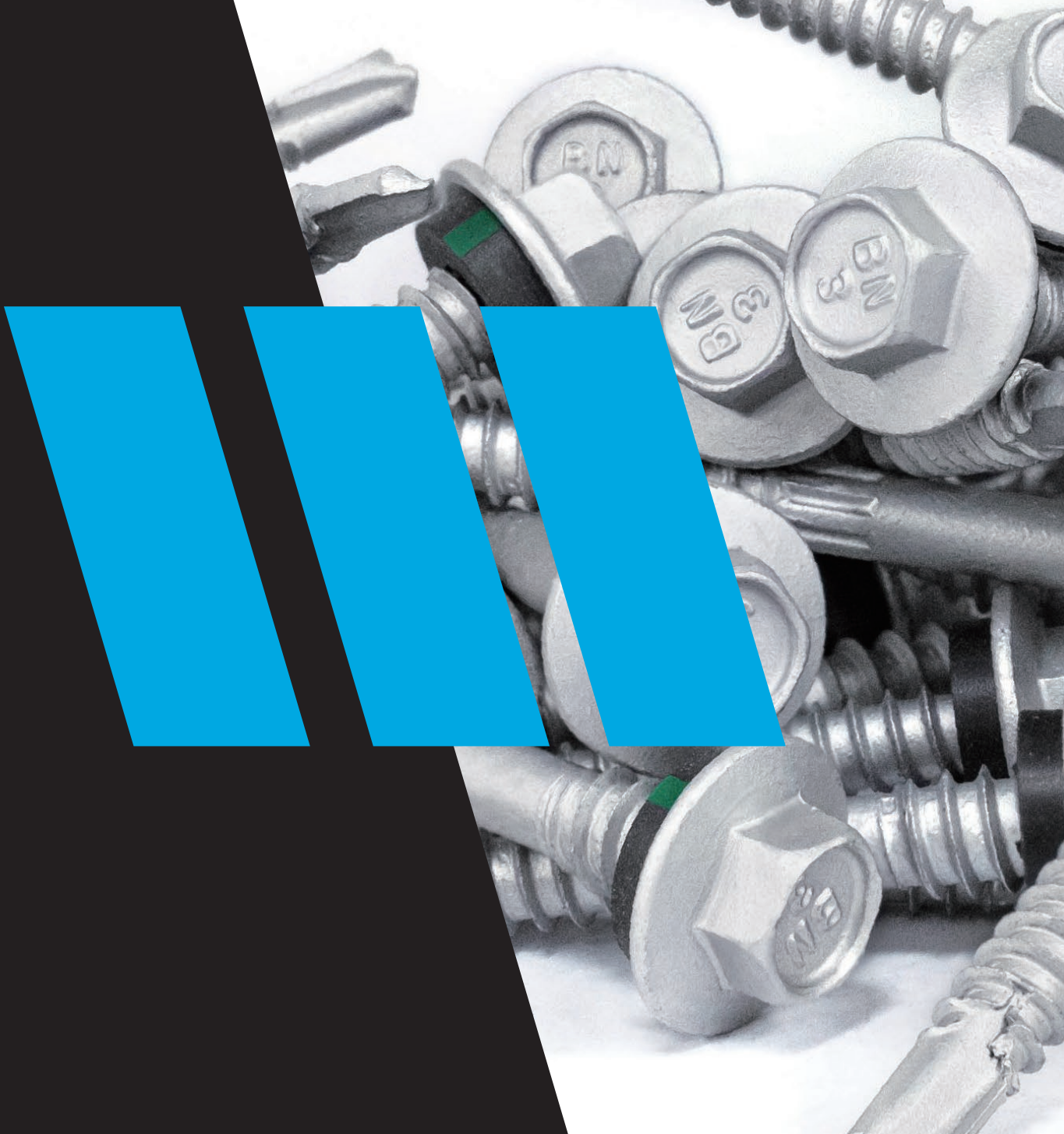

HEADQUARTER - TAIWAN

No. 47-37, Jiahua Rd., Gangshan, Kaohsiung 820, Taiwan (R.O.C.)

T +886 7-6282702 | F +886 7-6282601 | E info@bdfasteners.com

www.bdfasteners.com